

FORMER DAVITA FACILITY

# FEASTERVILLE-TREVOSE, PA

2 NESHAMINY INTERPLEX DRIVE, SUITE 110

±9,552 SF AVAILABLE FOR LEASE

PHILADELPHIA MSA

GROUND LEVEL SPACE WITH PRIVATE ENTRANCE



MetroCommercial.com | PLYMOUTH MEETING, PA | MOUNT LAUREL, NJ | MIAMI, FL | PHILADELPHIA, PA

get in touch.

**BRENT BARBEHENN**

office 856.866.1900

direct 856.222.3036





bbarbehenn@metrocommercial.com



# 45,571 TOTAL HOUSEHOLDS WITHIN 3 MILES



- 1 Mile
- 3 Mile
- 5 Mile

	1 Mile	3 Mile	5 Mile
 Total Population	8,192	118,212	293,755
 Total Households	3,203	45,571	113,247
 Med HH Income	\$74,573	\$73,977	\$77,375
 % HH > \$100k	37%	36%	38%

The information and images contained herein are from sources deemed reliable. However, Metro Commercial Real Estate, Inc. makes no representation whatsoever as to their accuracy or authenticity. Images shown may be modified for illustrative purposes. Images may be out-of-date and not current. 02.09.23

FORMER DAVITA FACILITY  
**FEASTERVILLE-TREVOSE, PA**  
 2 NESHAMINY INTERPLEX DRIVE, SUITE 110



MetroCommercial.com







# PART OF THE WELL-KNOWN NESHAMINY INTERPLEX OFFICE COMPLEX



±9,552 SF  
AVAILABLE

INTERPLEX DR

NORTHGATE DR

OLD LINCOLN HWY 11,298 VPD

Faulkner  
TO BE SURE



RH RADISSON  
HOTELS

The information and images contained herein are from sources deemed reliable. However, Metro Commercial Real Estate, Inc. makes no representation whatsoever as to their accuracy or authenticity. Images shown may be modified for illustrative purposes. Images may be out-of-date and not current. 2.02.23

FORMER DAVITA FACILITY  
**FEASTERVILLE-TREVOSE, PA**  
2 NESHAMINY INTERPLEX DRIVE, SUITE 110



MetroCommercial.com



**±9,552 SF  
AVAILABLE**

NEW LANDINGS AND RAMP

NEW LANDINGS AND RAMP

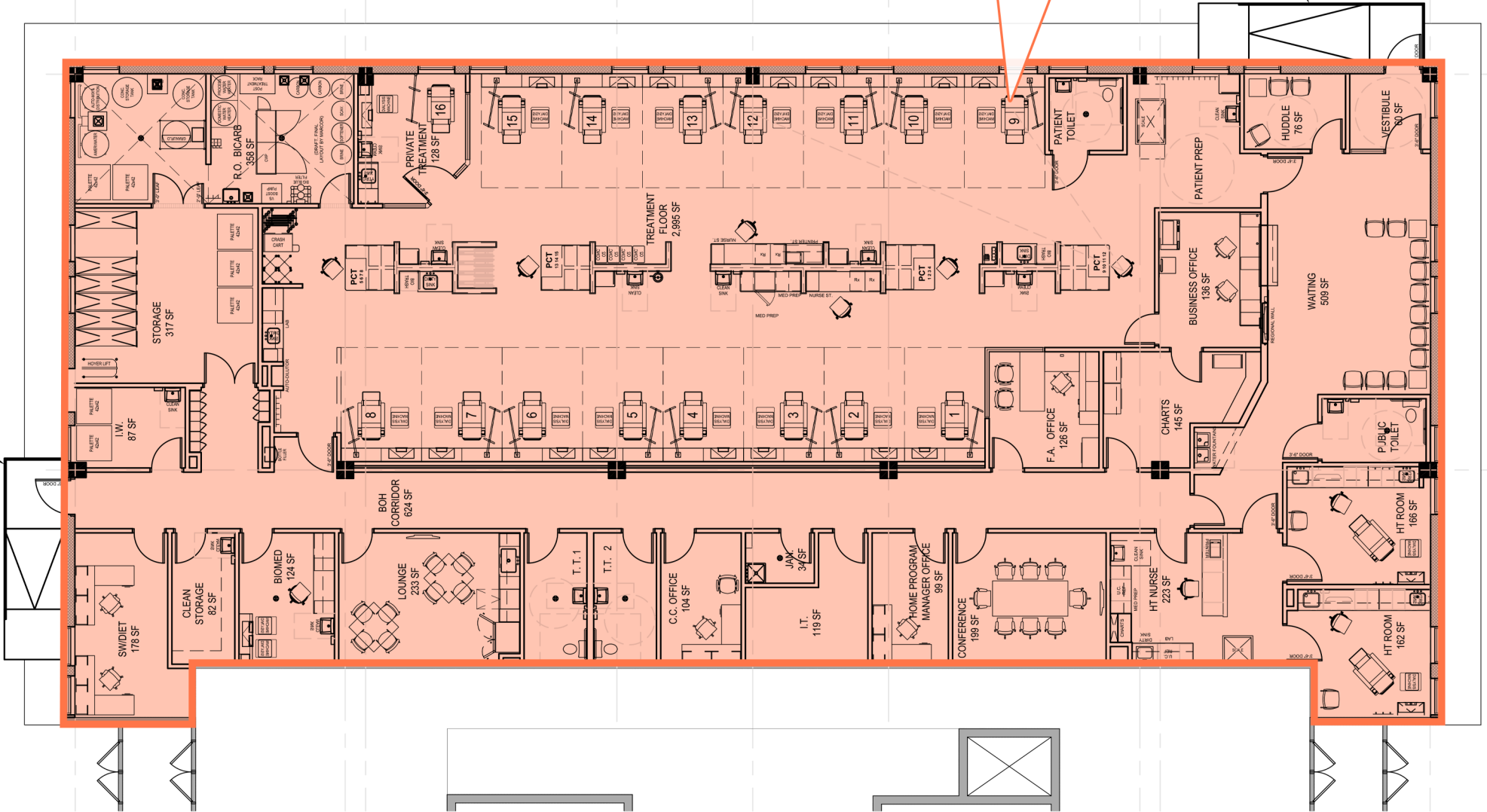

The information and images contained herein are from sources deemed reliable. However, Metro Commercial Real Estate, Inc. makes no representation whatsoever as to their accuracy or authenticity. Images shown may be modified for illustrative purposes. Images may be out-of-date and not current. 02.09.23

FORMER DAVITA FACILITY  
**FEASTERVILLE-TREVOSE, PA**  
2 NESHAMINY INTERPLEX DRIVE, SUITE 110



MetroCommercial.com