

ELEMENTS CHESTERBROOK

# WAYNE, PA

12 WEST ANTHONY WAYNE DRIVE

±1,337 SF AVAILABLE FOR LEASE OR SALE

JOIN



**STRONG SMALL SHOP OPPORTUNITY FOR TRADITIONAL RETAIL, FINANCIAL SERVICES, MEDICAL AND MORE!**



**METRO**<sup>®</sup>  
COMMERCIAL  
REAL ESTATE, INC.

MetroCommercial.com | PLYMOUTH MEETING, PA | MOUNT LAUREL, NJ | MIAMI, FL

**get in touch.**

**DAVID JUDD**

office 856.866.1900  
direct 856.222.3037  
djudd@metrocommercial.com

**ANDREW SHPIGEL**

office 215.893.0300  
direct 215.282.0153  
ashpigel@metrocommercial.com

# EXCEPTIONAL AVERAGE HOUSEHOLD INCOMES AND STRONG DAYTIME POPULATION WITHIN THE TRADE AREA

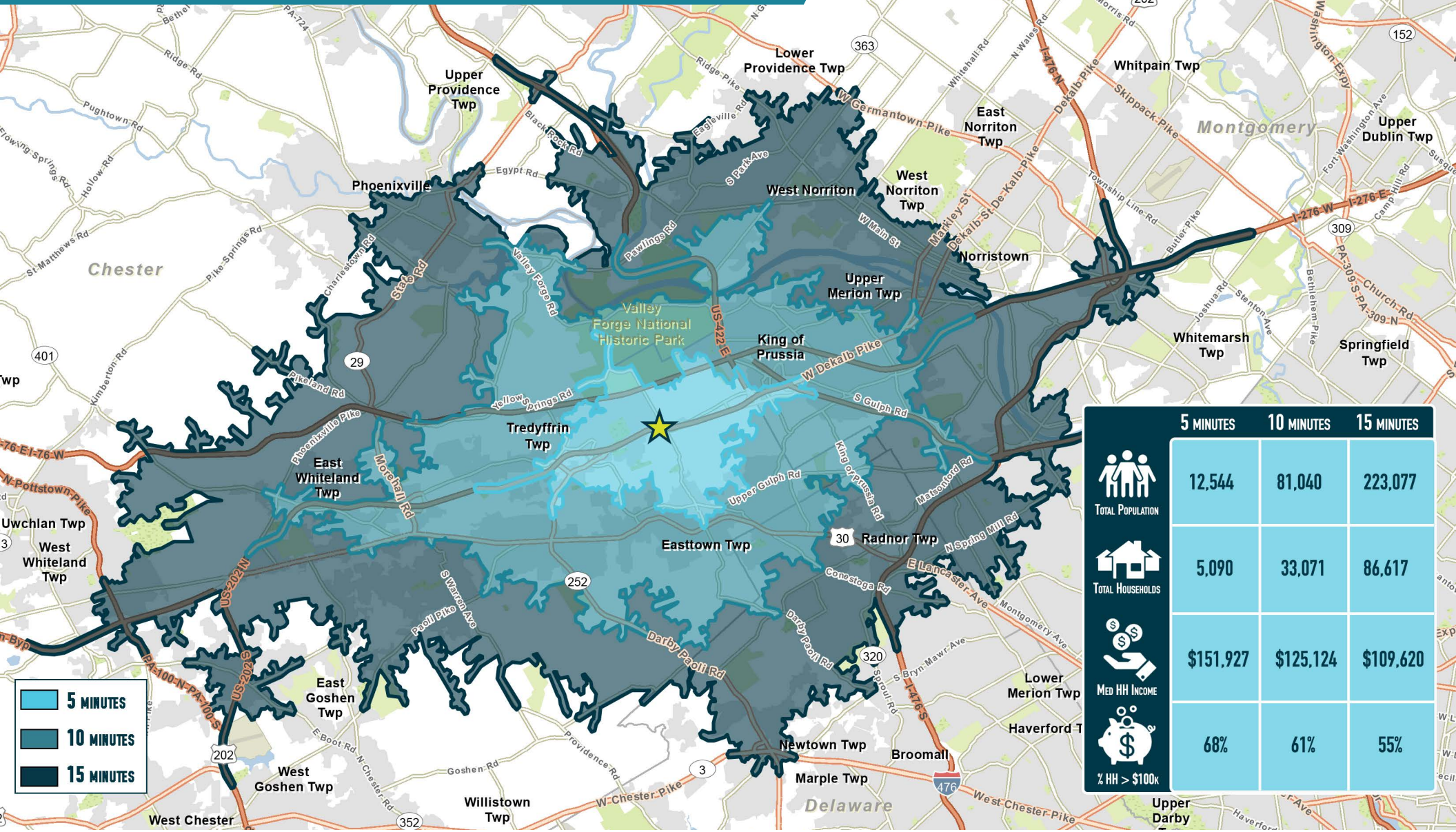

	5 MINUTES	10 MINUTES	15 MINUTES
TOTAL POPULATION	12,544	81,040	223,077
TOTAL HOUSEHOLDS	5,090	33,071	86,617
MED HH INCOME	\$151,927	\$125,124	\$109,620
% HH > \$100k	68%	61%	55%

The information and images contained herein are from sources deemed reliable. However, Metro Commercial Real Estate, Inc. makes no representation whatsoever as to their accuracy or authenticity. Images shown may be modified for illustrative purposes. Images may be out-of-date and not current. 08.29.22

ELEMENTS CHESTERBROOK  
**WAYNE, PA**  
 12 WEST ANTHONY WAYNE DRIVE



[www.metrocommercial.com](http://www.metrocommercial.com)

# EASY ACCESS TO THE ROUTE 202



The information and images contained herein are from sources deemed reliable. However, Metro Commercial Real Estate, Inc. makes no representation whatsoever as to their accuracy or authenticity. Images shown may be modified for illustrative purposes. Images may be out-of-date and not current. 08.29.22

ELEMENTS CHESTERBROOK  
**WAYNE, PA**  
12 WEST ANTHONY WAYNE DRIVE



www.metrocommercial.com

LOCATED ACROSS FROM GATEWAY SHOPPING CENTER AT THE SIGNALIZED INTERSECTION OF ROUTE 252 AND W ANTHONY DRIVE

**SITE**  
**AVAILABLE**  
**±1,337 SF**

**ANTHONY WAYNE DRIVE**



**PYLON**

**BLACK POWDER TAVERN**



**SWEDESFORD ROAD 6,597 VPD**



**88,917 VPD**

**VALLEY FORGE ROAD 10,664 VPD**



The information and images contained herein are from sources deemed reliable. However, Metro Commercial Real Estate, Inc. makes no representation whatsoever as to their accuracy or authenticity. Images shown may be modified for illustrative purposes. Images may be out-of-date and not current. 11.4.20

**ELEMENTS CHESTERBROOK**  
**WAYNE, PA**  
12 WEST ANTHONY WAYNE DRIVE



[www.metrocommercial.com](http://www.metrocommercial.com)

# PRIME PYLON SIGNAGE AVAILABLE

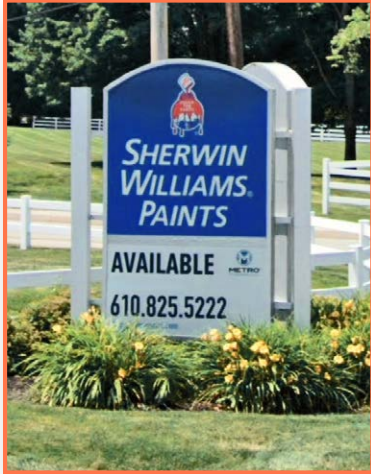

**VALLEY FORGE ROAD**  
 (A.K.A. PENNSYLVANIA STATE HIGHWAY ROUTE 282)  
 (A.K.A. L.R. 449 SPUR A)  
 (100' WIDE ROAD)

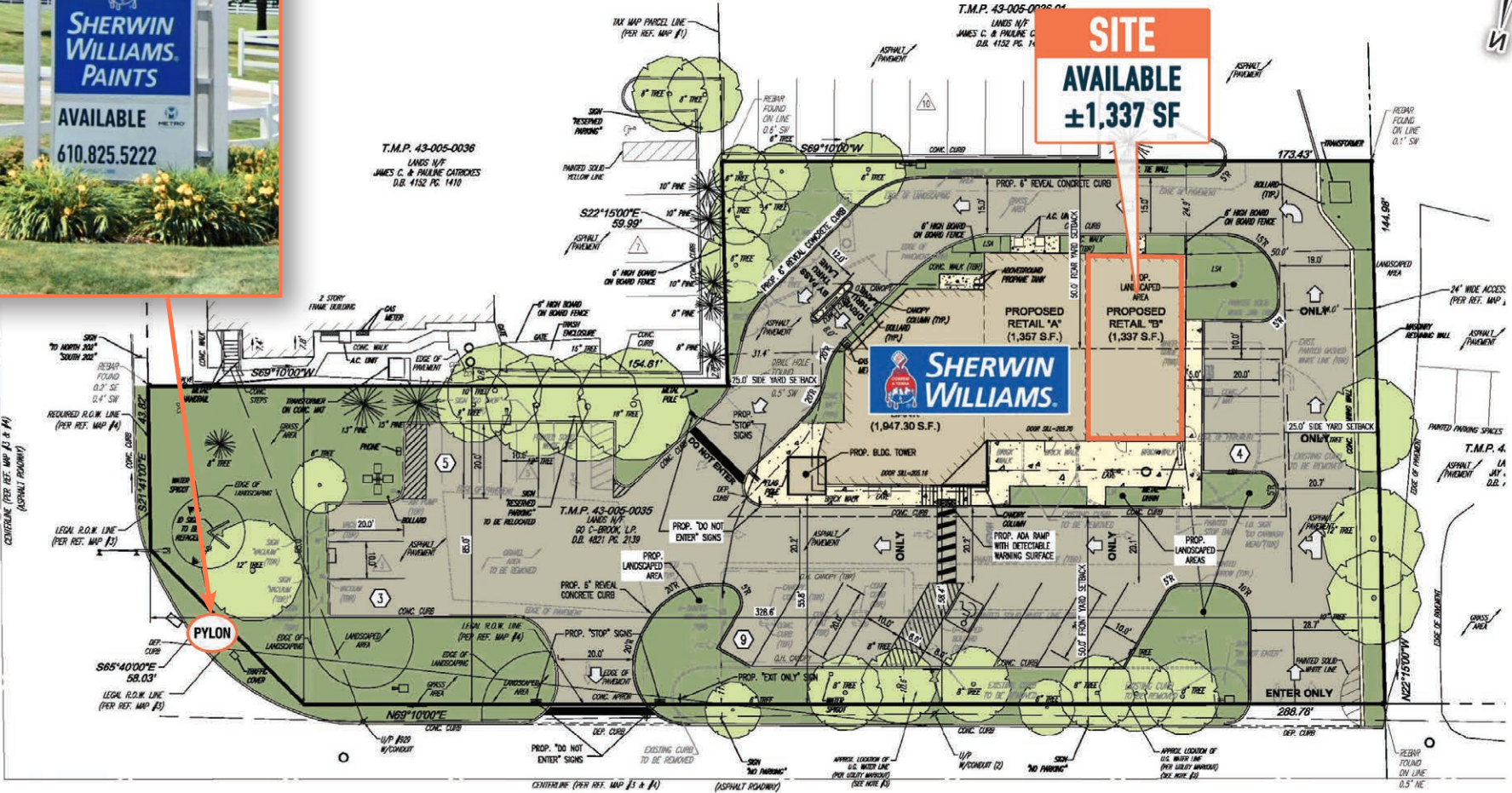

**WEST ANTHONY WAYNE DRIVE**  
 (A.K.A. RELOCATED T-583)  
 (40' WIDE LEGAL R.D.W.)

The information and images contained herein are from sources deemed reliable. However, Metro Commercial Real Estate, Inc. makes no representation whatsoever as to their accuracy or authenticity. Images shown may be modified for illustrative purposes. Images may be out-of-date and not current. 08.29.22

ELEMENTS CHESTERBROOK  
**WAYNE, PA**  
 12 WEST ANTHONY WAYNE DRIVE



[www.metrocommercial.com](http://www.metrocommercial.com)

# PROPERTY PHOTOS



The information and images contained herein are from sources deemed reliable. However, Metro Commercial Real Estate, Inc. makes no representation whatsoever as to their accuracy or authenticity. Images shown may be modified for illustrative purposes. Images may be out-of-date and not current. 08.29.22

ELEMENTS CHESTERBROOK  
**WAYNE, PA**  
12 WEST ANTHONY WAYNE DRIVE



[www.metrocommercial.com](http://www.metrocommercial.com)