

PHILADELPHIA, PA

1528 CHESTNUT STREET

±25,855 SF AVAILABLE FOR LEASE

PHILADELPHIA MSA

±25,855 SF AVAILABLE FOR LEASE OVER THREE FLOORS



VIRTUAL TOUR



MetroCommercial.com | PLYMOUTH MEETING, PA | MOUNT LAUREL, NJ | MIAMI, FL | PHILADELPHIA, PA

property highlights.

- Rare large-format freestanding building on one of Philadelphia's dominant shopping streets
- Surrounded by national shops and restaurants including:
 - UNI QLO
 - NORDSTROM rack
 - J.CREW
 - SEPHORA
 - Puttshack
 - bloomingdales the outlet store
- Heavily trafficked day, evening and weekend location

get in touch.

MICHAEL GORMAN

office 215.893.0300
direct 215.893.0133
mgorman@metrocommercial.com

SCOTT BENSON

office 215.893.0300
direct 215.893.0158
sbenson@metrocommercial.com

<p>1723 - Foreign Bazaar 1719 - William Penn House Co-Op Apt.</p> <p>1911 - The Laurel Condominiums 1911 - Proposed Equinox</p> <p>1900 - Born Yesterday</p> <p>1849 - PNC Bank</p> <p>1847 - Trust Bank</p> <p>1845 - Office Building</p> <p>1845 - Venditore by Giordano</p> <p>Parking Garage</p> <p>1811 - Proposed Rescue Spa</p> <p>1805 - Proposed Stephen Starr</p> <p>1801</p>	<p>1910 - Photo Lounge 1907 - Devil's Alley 1905 - Drinker's Pub 1901 - Jeni's Splendid Ice Creams</p> <p>1839 - Bank of Princeton 1837 - Crazy Sushi 1835 - Mandarin Palace Chinese Rest. 1831 - William Schwartz Jewelry 1831 - Roost Apt. Hotel</p> <p>Boys' Parking Lot</p> <p>1813 - Sweet Green</p> <p>1811 - Bundy Computers</p> <p>1807</p> <p>1805 - Blue Sole Shoes</p> <p>1801 - The Continental</p>	<p>1737 - T-Mobile 1735 - Hey Day 1733 - Sugar + Bronze 1731 - Just Salad 1729 - Second Federal Savings 1725 - The Shade Store 1723 - Kura Sushi 1719 - Grace Loves Lace 1717 - Paris Baguette 1711 - For Eyes 1709 - Starbucks 1705 - Proposed Sunglass Hut 1703 - Liberty Time 1701 - The Vitamin Shoppe</p> <p>1625</p> <p>1625</p> <p>1625</p> <p>1625</p> <p>1625</p> <p>1625</p> <p>1625</p>	<p>1601 - TD Ameritrade 1601 - Sweigreen 1601 - Republic Bank</p> <p>1515 - First Trust 1515 - Citizens Bank</p> <p>1500</p> <p>Starbucks - 1500</p>	<p>1601 - TD Ameritrade 1601 - Sweigreen 1601 - Republic Bank</p> <p>1515 - First Trust 1515 - Citizens Bank</p> <p>1500</p> <p>Starbucks - 1500</p>	 <p>CITY HALL</p>
<p>1910 - Bankroll</p> <p>1904</p> <p>1902</p> <p>1900</p> <p>1826</p> <p>1824</p> <p>1822</p> <p>1818</p> <p>1814-17</p> <p>1812-14</p> <p>1816</p> <p>1808-10</p> <p>1806</p> <p>1804</p> <p>1802</p> <p>1800</p>	<p>CVS - 1826</p> <p>1824</p> <p>1822</p> <p>1818</p> <p>1814-17</p> <p>1812-14</p> <p>1816</p> <p>1808-10</p> <p>1806</p> <p>1804</p> <p>1802</p> <p>1800</p>	<p>1736</p> <p>MAC - 1734</p> <p>1730-32</p> <p>1728</p> <p>1726</p> <p>1724</p> <p>1718</p> <p>1716</p> <p>1714</p> <p>1712</p> <p>1704</p> <p>1700</p>	<p>1628</p> <p>1628</p> <p>1628</p> <p>1626</p> <p>1622</p> <p>1618</p> <p>1616</p> <p>1614</p> <p>1608</p> <p>1606</p> <p>1604</p> <p>1600</p>	<p>1530</p> <p>1526</p> <p>1522</p> <p>1520</p> <p>1518</p> <p>1516</p> <p>1514</p> <p>1512</p> <p>1508</p> <p>1500</p>	<p>1426</p> <p>1424</p> <p>1422</p> <p>1416</p> <p>1414</p> <p>1412</p> <p>1410</p> <p>1408</p>
<p>1910 - Bankroll</p> <p>1904</p> <p>1902</p> <p>1900</p> <p>1826</p> <p>1824</p> <p>1822</p> <p>1818</p> <p>1814-17</p> <p>1812-14</p> <p>1816</p> <p>1808-10</p> <p>1806</p> <p>1804</p> <p>1802</p> <p>1800</p>	<p>CVS - 1826</p> <p>1824</p> <p>1822</p> <p>1818</p> <p>1814-17</p> <p>1812-14</p> <p>1816</p> <p>1808-10</p> <p>1806</p> <p>1804</p> <p>1802</p> <p>1800</p>	<p>1736</p> <p>MAC - 1734</p> <p>1730-32</p> <p>1728</p> <p>1726</p> <p>1724</p> <p>1718</p> <p>1716</p> <p>1714</p> <p>1712</p> <p>1704</p> <p>1700</p>	<p>1628</p> <p>1628</p> <p>1628</p> <p>1626</p> <p>1622</p> <p>1618</p> <p>1616</p> <p>1614</p> <p>1608</p> <p>1606</p> <p>1604</p> <p>1600</p>	<p>1530</p> <p>1526</p> <p>1522</p> <p>1520</p> <p>1518</p> <p>1516</p> <p>1514</p> <p>1512</p> <p>1508</p> <p>1500</p>	<p>1426</p> <p>1424</p> <p>1422</p> <p>1416</p> <p>1414</p> <p>1412</p> <p>1410</p> <p>1408</p>
<p>1910 - Bankroll</p> <p>1904</p> <p>1902</p> <p>1900</p> <p>1826</p> <p>1824</p> <p>1822</p> <p>1818</p> <p>1814-17</p> <p>1812-14</p> <p>1816</p> <p>1808-10</p> <p>1806</p> <p>1804</p> <p>1802</p> <p>1800</p>	<p>CVS - 1826</p> <p>1824</p> <p>1822</p> <p>1818</p> <p>1814-17</p> <p>1812-14</p> <p>1816</p> <p>1808-10</p> <p>1806</p> <p>1804</p> <p>1802</p> <p>1800</p>	<p>1736</p> <p>MAC - 1734</p> <p>1730-32</p> <p>1728</p> <p>1726</p> <p>1724</p> <p>1718</p> <p>1716</p> <p>1714</p> <p>1712</p> <p>1704</p> <p>1700</p>	<p>1628</p> <p>1628</p> <p>1628</p> <p>1626</p> <p>1622</p> <p>1618</p> <p>1616</p> <p>1614</p> <p>1608</p> <p>1606</p> <p>1604</p> <p>1600</p>	<p>1530</p> <p>1526</p> <p>1522</p> <p>1520</p> <p>1518</p> <p>1516</p> <p>1514</p> <p>1512</p> <p>1508</p> <p>1500</p>	<p>1426</p> <p>1424</p> <p>1422</p> <p>1416</p> <p>1414</p> <p>1412</p> <p>1410</p> <p>1408</p>
<p>1910 - Bankroll</p> <p>1904</p> <p>1902</p> <p>1900</p> <p>1826</p> <p>1824</p> <p>1822</p> <p>1818</p> <p>1814-17</p> <p>1812-14</p> <p>1816</p> <p>1808-10</p> <p>1806</p> <p>1804</p> <p>1802</p> <p>1800</p>	<p>CVS - 1826</p> <p>1824</p> <p>1822</p> <p>1818</p> <p>1814-17</p> <p>1812-14</p> <p>1816</p> <p>1808-10</p> <p>1806</p> <p>1804</p> <p>1802</p> <p>1800</p>	<p>1736</p> <p>MAC - 1734</p> <p>1730-32</p> <p>1728</p> <p>1726</p> <p>1724</p> <p>1718</p> <p>1716</p> <p>1714</p> <p>1712</p> <p>1704</p> <p>1700</p>	<p>1628</p> <p>1628</p> <p>1628</p> <p>1626</p> <p>1622</p> <p>1618</p> <p>1616</p> <p>1614</p> <p>1608</p> <p>1606</p> <p>1604</p> <p>1600</p>	<p>1530</p> <p>1526</p> <p>1522</p> <p>1520</p> <p>1518</p> <p>1516</p> <p>1514</p> <p>1512</p> <p>1508</p> <p>1500</p>	<p>1426</p> <p>1424</p> <p>1422</p> <p>1416</p> <p>1414</p> <p>1412</p> <p>1410</p> <p>1408</p>

From sources deemed reliable. However, Metro Commercial Real Estate, Inc. makes no representation whatsoever as to their accuracy or authenticity. Images shown may be modified for illustrative purposes. Images may be out-of-date and not current. 3.24.23

SITE PLAN

SECOND FLOOR

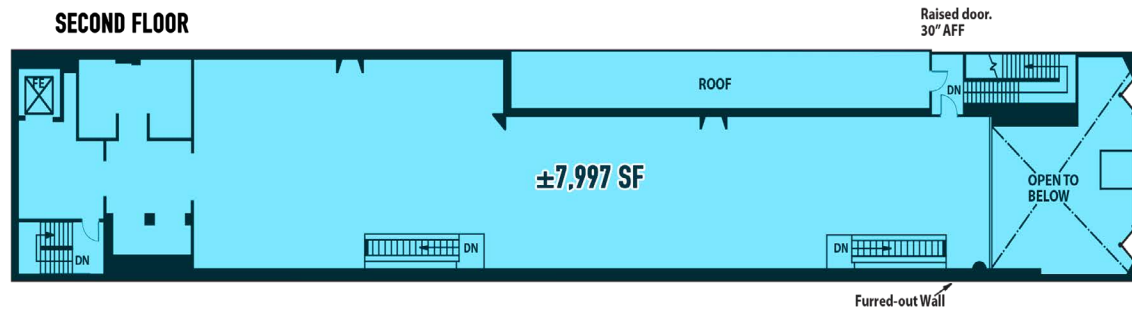

GROUND FLOOR

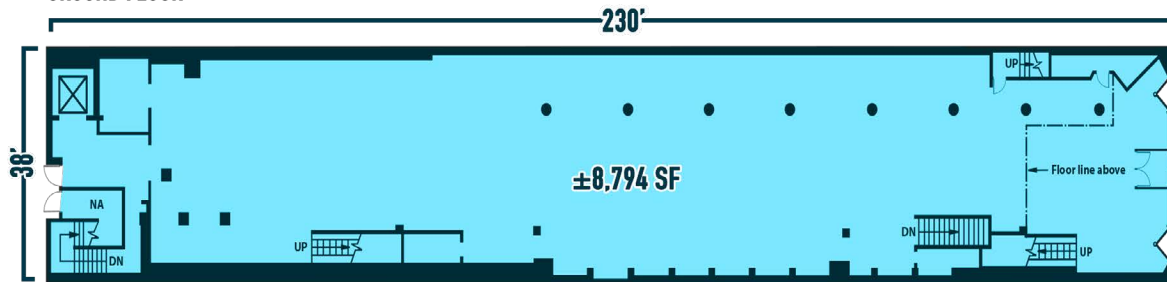

LOWER LEVEL



The information and images contained herein are from sources deemed reliable. However, Metro Commercial Real Estate, Inc. makes no representation whatsoever as to their accuracy or authenticity. Images shown may be modified for illustrative purposes. Images may be out-of-date and not current. 03.28.23