

WARMINSTER, PA

1133 YORK ROAD

±1,571 - 29,195 SF AVAILABLE FOR LEASE

PHILADELPHIA MSA



±29,195 SF NOW AVAILABLE NEXT TO NEW WEIS MARKETS



LEASED BY:



METRO[®]
COMMERCIAL
REAL ESTATE, INC.

OWNED & MANAGED BY:



get in touch.

BRENDAN MULLIGAN

office 610.825.5222

direct 610.260.2688

bmulligan@metrocommercial.com

37,949 TOTAL HOUSEHOLDS WITHIN A 10 MINUTE DRIVE TIME

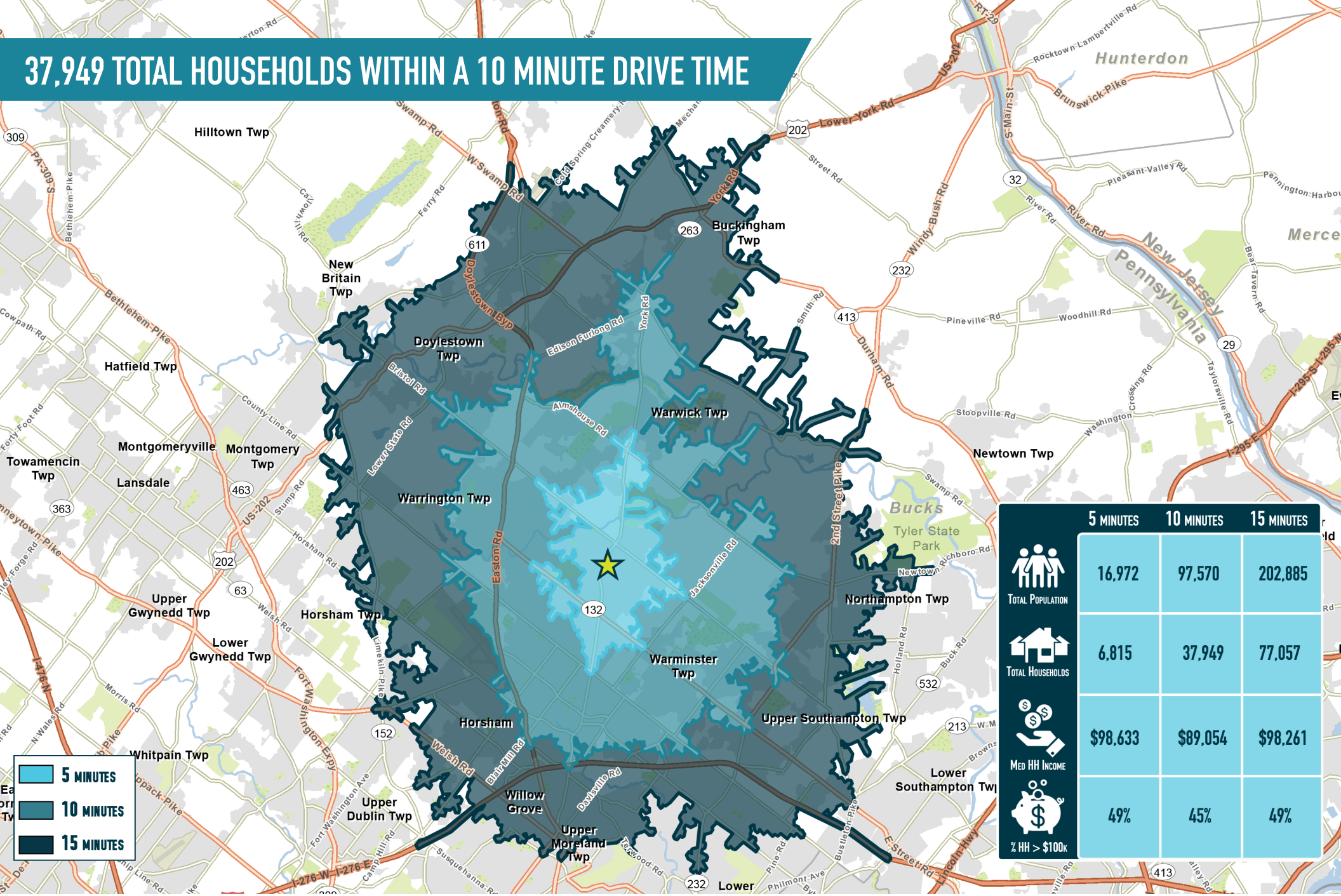

The information and images contained herein are from sources deemed reliable. However, Metro Commercial Real Estate, Inc. makes no representation whatsoever as to their accuracy or authenticity. Images shown may be modified for illustrative purposes. Images may be out-of-date and not current. 11.20.23

WARMINSTER, PA
1133 YORK ROAD



www.metrocommercial.com

1 MILE NORTH OF STREET ROAD AND YORK ROAD INTERSECTION



The information and images contained herein are from sources deemed reliable. However, Metro Commercial Real Estate, Inc. makes no representation whatsoever as to their accuracy or authenticity. Images shown may be modified for illustrative purposes. Images may be out-of-date and not current. 11.20.23

WARMINSTER, PA
1133 YORK ROAD



www.metrocommercial.com

TARGETING FITNESS, DISCOUNT, MEDICAL, AND APPAREL TENANTS



The information and images contained herein are from sources deemed reliable. However, Metro Commercial Real Estate, Inc. makes no representation whatsoever as to their accuracy or authenticity. Images shown may be modified for illustrative purposes. Images may be out-of-date and not current. 11.20.23

WARMINSTER, PA
1133 YORK ROAD



www.metrocommercial.com

SITE PLAN

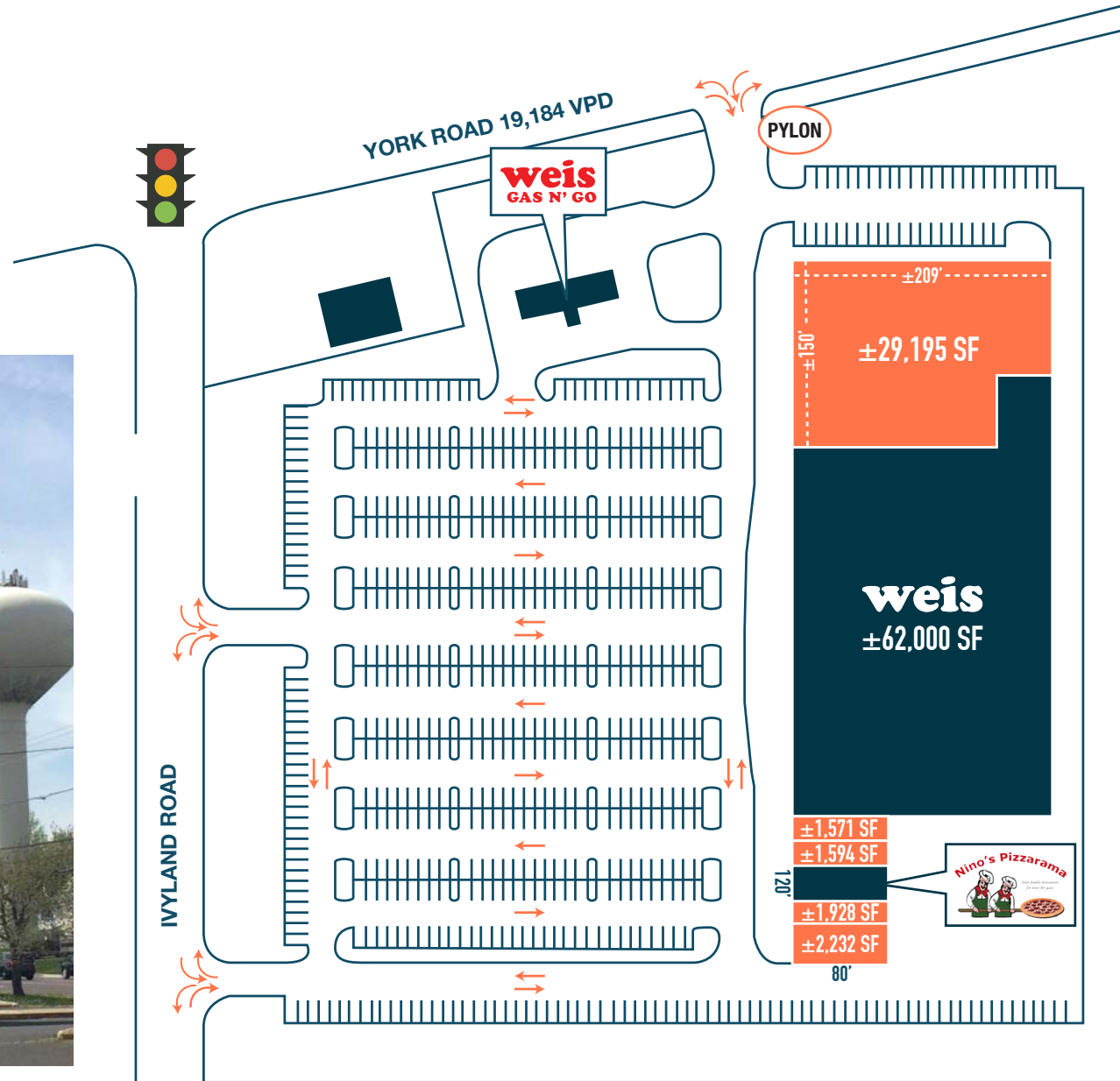
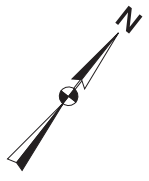

The information and images contained herein are from sources deemed reliable. However, Metro Commercial Real Estate, Inc. makes no representation whatsoever as to their accuracy or authenticity. Images shown may be modified for illustrative purposes. Images may be out-of-date and not current. 11.20.23

WARMINSTER, PA
1133 YORK ROAD



www.metrocommercial.com

SMALL SHOP PLAN

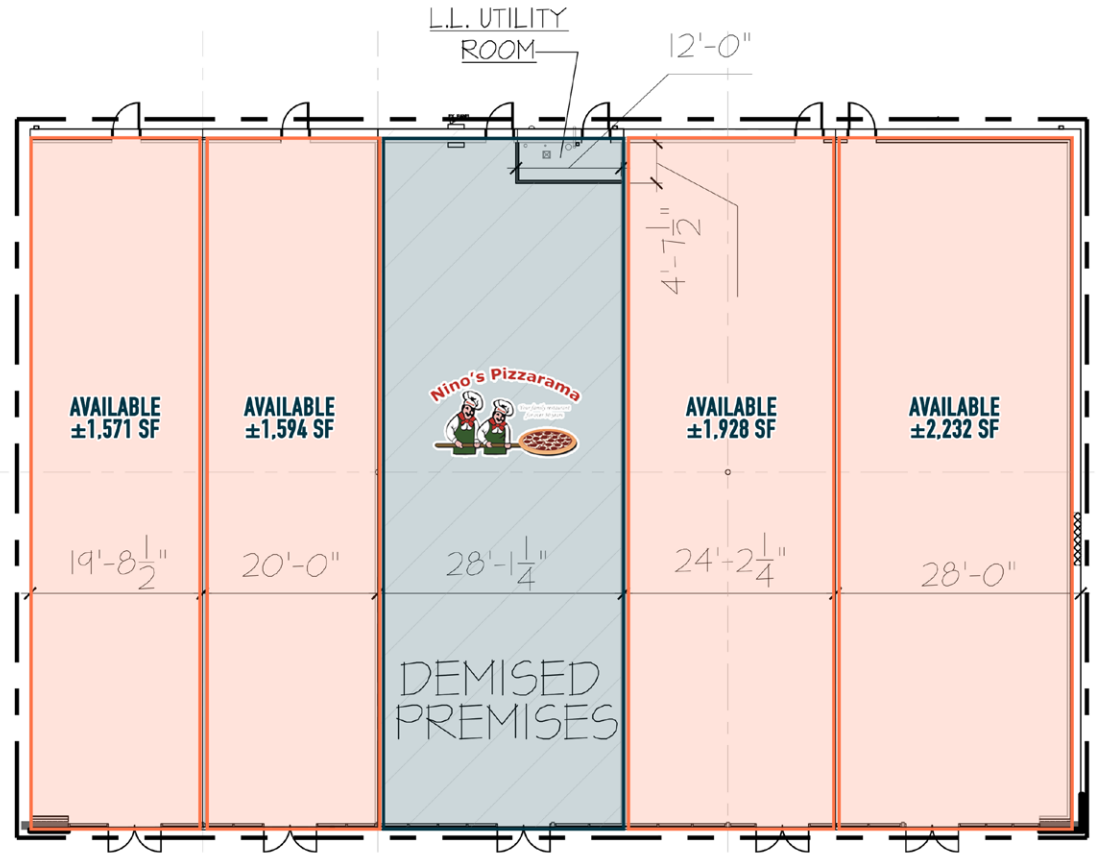

The information and images contained herein are from sources deemed reliable. However, Metro Commercial Real Estate, Inc. makes no representation whatsoever as to their accuracy or authenticity. Images shown may be modified for illustrative purposes. Images may be out-of-date and not current. 11.20.23

WARMINSTER, PA
1133 YORK ROAD



www.metrocommercial.com